

Scale 1"=20'

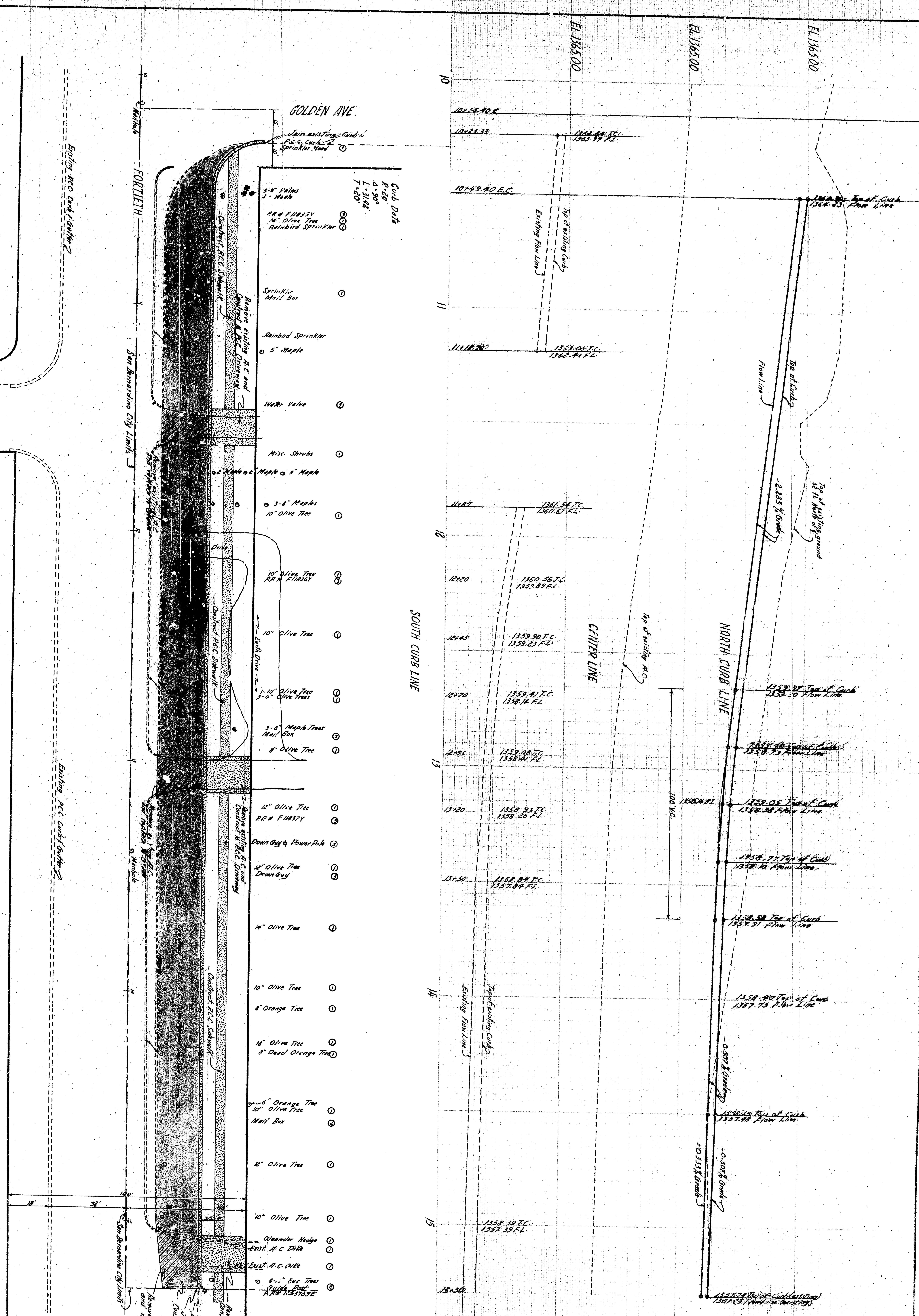

GENERAL NOTES

1. All work indicated on these plans shall be done in accordance with applicable provisions of Standard Specifications for Highway and Street Construction, 1962 Edition, as published by the Office of the State Engineer.
2. Obstructions (Markings and Signs) shall be placed by the Engineer.
3. To be removed under this contract.
4. To be removed and replaced by the Contractor.
5. When Contractor's plans and specifications are approved, the Contractor shall provide and install a 24-hour watchman during the construction period.
6. Special provisions shall be included in the contract and specifications for the protection of existing utilities, structures, and other property.
7. The Contractor shall be responsible for the protection of all existing utilities, structures, and other property.
8. The Contractor shall be responsible for the protection of all existing utilities, structures, and other property.
9. The Contractor shall be responsible for the protection of all existing utilities, structures, and other property.
10. The Contractor shall be responsible for the protection of all existing utilities, structures, and other property.

PROFILE
Scale: 1"=10'
Vertical: 1"=10'

APPROVED: *[Signature]* 2/1/62
REGISTERED CIVIL ENGINEER NO. 2853
CITY OF SAN BERNARDINO
DRAWING NO. 3531
CHECKED BY: *[Signature]*
RECOMMENDED BY: *[Signature]*
SHEETS 3 OF 5
SHEETS 5 SHEETS

DEPARTMENT OF ENGINEERING
CITY OF SAN BERNARDINO
FORTTETH STREET
Between Harrison Street and Mountain Avenue
Waterways - North Side